



**2/1, 30 NITHSDALE ROAD**

**STRATHBUNGO**

[www.corumproperty.co.uk](http://www.corumproperty.co.uk)



2 | BEDROOMS  
1 | SHOWER ROOM  
1 | PUBLIC ROOM

Positioned at top floor level in a handsome tenement building, this particularly bright home is found in the bustling conservation area of Strathbungo. The property has been refurbished by our client and it is ready for a new owner to put their own stamp on it.

- Bright top floor tenement flat
- Available for immediate entry
- Two double sized bedrooms
- Fitted dining kitchen to rear
- Gas heating & triple glazing
- Numerous amenities nearby

Amenities

30 Nithsdale Road is in the popular Southside community of Strathbungo where independent restaurants, shops, bars and coffee houses jostle for position. Queen's Park is approximately 350 yards away providing excellent recreational space, tennis courts and a recently regenerated bandstand/arena. Queen's Park and Pollokshields West train stations are within half a mile of the front door whilst numerous bus routes are available on Pollokshaws Road.

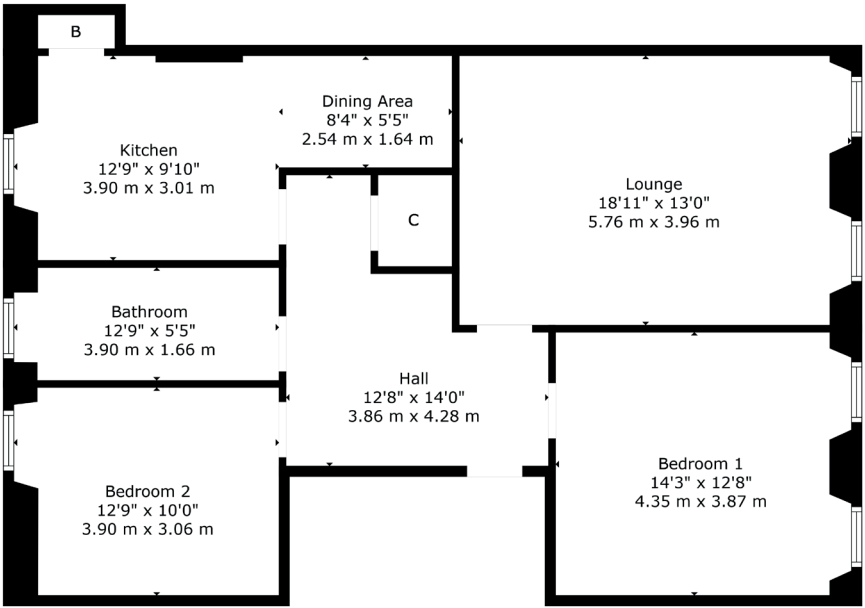

Sat Nav:  
30 Nithsdale Road, Strathbungo, G41 2AN  
SS4993

\*All measurements and distances are approximate.  
Floorplans are for illustration purposes and may not be to scale.

For the full home report visit  
[www.corumproperty.co.uk](http://www.corumproperty.co.uk)



WE'RE **SOLD** ON  
YOUR FUTURE



Corum Shawlands  
247 Kilmarnock Road, Shawlands, G41 3JF

**Tel:** 0141 636 7588

**Email:** [shawlands@corumproperty.co.uk](mailto:shawlands@corumproperty.co.uk)

[www.corumproperty.co.uk](http://www.corumproperty.co.uk)