



**2/1, 116 QUEENS DRIVE**

QUEENS PARK

[www.corumproperty.co.uk](http://www.corumproperty.co.uk)





3 | BEDROOMS  
1 | BATHROOM  
1 | PUBLIC ROOM

Set on Balmoral Terrace, opposite Queen’s Park, this spacious second floor flat is presented to the market in great order throughout.

- Renowned sandstone building
- First floor townflat
- Impressive lounge with bay window
- Three bedrooms
- Well appointed kitchen and bathroom
- Excellent local amenities

Amenities

116 Queens Drive is within walking distance of shops and amenities upon Victoria Road or Pollokshaws Road where thriving coffee shops, restaurants, bars and delicatessens can be found. More extensive amenities are available at the Marks & Spencer store at Queens Park, the Morrison’s store at Crossmyloof or the Silverburn Shopping Centre at Pollok.

Recreational pursuits within the area are found across the road at Queens Park including nature trails, all weather football pitches and tennis courts. Regular public transport services (both bus and rail) provide commuter access to the city centre. The local railway station is approximately 300 yards walk from the front door.

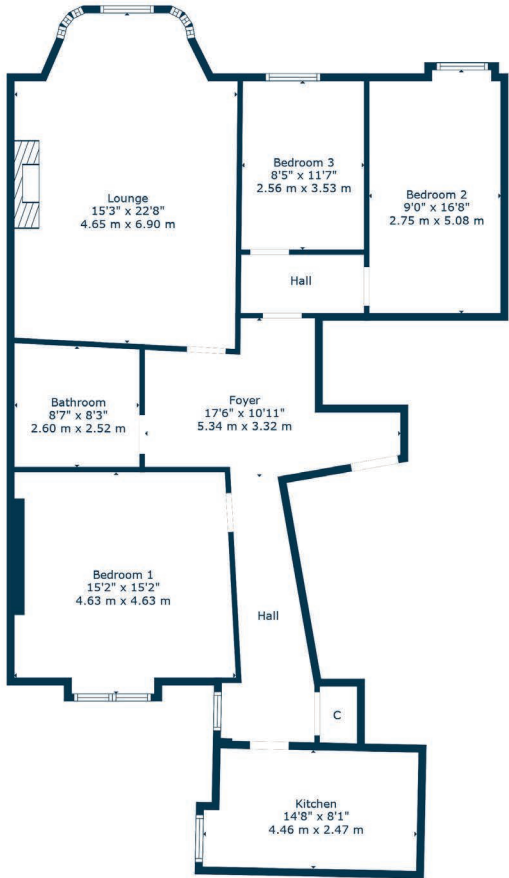

Sat Nav:  
2/1, 116 Queens Drive, Queens Park, G42 8BJ

SS5027

\*All measurements and distances are approximate.  
Floorplans are for illustration purposes and may not be to scale.

For the full home report visit  
[www.corumproperty.co.uk](http://www.corumproperty.co.uk)



WE'RE **SOLD** ON  
YOUR FUTURE



Corum Shawlands  
247 Kilmarnock Road, Shawlands, G41 3JF

Tel: 0141 636 7588

Email: [shawlands@corumproperty.co.uk](mailto:shawlands@corumproperty.co.uk)

[www.corumproperty.co.uk](http://www.corumproperty.co.uk)