



# 33 MARYWOOD SQUARE

STRATHBUNGO

[www.corumproperty.co.uk](http://www.corumproperty.co.uk)





2 | BEDROOMS  
1 | BATHROOM  
1 | PUBLIC ROOM

Positioned at garden level in an attractive sandstone terrace, this two bedroom conversion is found in the bustling Strathbungo district. The building was divided some years ago to house three properties and our client's home has both the front and back garden.

- Main door garden level conversion
- Fitted kitchen opening to garden
- Two versatile double bedrooms
- Private gardens front and rear
- Off street parking via back lane
- Numerous amenities nearby

Amenities

33 Marywood Square is in the popular Southside community of Strathbungo where independent restaurants, shops, bars and coffee houses are all in close proximity. Queen's Park is approximately 300 yards away providing excellent recreational space, tennis courts, a playpark and a recently regenerated bandstand/arena. Pollokshields West and Queens Park train stations are both within half a mile of the front door whilst numerous bus routes are available around the corner on Pollokshaws Road.

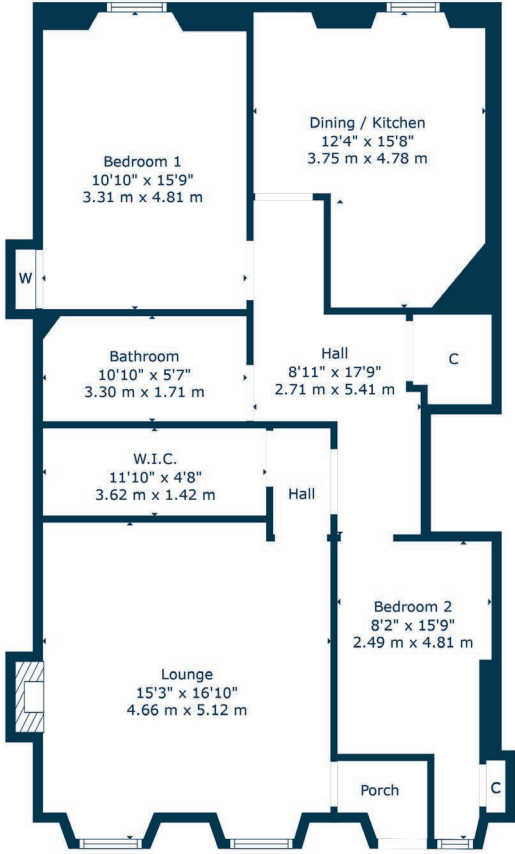

Sat Nav:  
33 Marywood Square, Strathbungo, G41 2BN

SS5035

\*All measurements and distances are approximate.  
Floorplans are for illustration purposes and may not be to scale.

For the full home report visit  
[www.corumproperty.co.uk](http://www.corumproperty.co.uk)





WE'RE **SOLD** ON  
YOUR FUTURE



Corum Shawlands  
247 Kilmarnock Road, Shawlands, G41 3JF

**Tel:** 0141 636 7588  
**Email:** [shawlands@corumproperty.co.uk](mailto:shawlands@corumproperty.co.uk)

[www.corumproperty.co.uk](http://www.corumproperty.co.uk)