



**34 CRAIG HILL PLACE**  
FAIRLIE

[www.corumproperty.co.uk](http://www.corumproperty.co.uk)







**3 | BEDROOMS**

**2 | BATHROOMS**

**1 | PUBLIC ROOM**

**This immaculate modern detached villa is located in this popular address in the coastal village of Fairlie. Fairlie is a picturesque villa on the North Ayrshire coastline with train access to destinations further afield along with close proximity to Largs yacht haven marina.**

34 Craig Hill Place is a wonderful modern detached home with lovely private garden grounds. The development by Dawn homes sits above the coastal village of Fairlie which is a quaint and picturesque village allowing access to Largs where many further amenities can be found.

The immaculate accommodation on offer extends to a welcoming reception hallway, good sized lounge with a bay window to the front, a modern dining kitchen which is an excellent social space allowing access to the rear garden grounds and wc. On the upper level there can be found three bedrooms, the master bedroom has an excellent en-suite and to complement this floor of the home there is the family bathroom. The property has gas central heating and double glazing. There are pleasant garden grounds to the rear with a pergola and sitting area along with patio & lawn. There is the driveway to the side of the home and gardens to the front. Early viewing is highly recommended to appreciate the location and accommodation on offer.

















Ground Floor

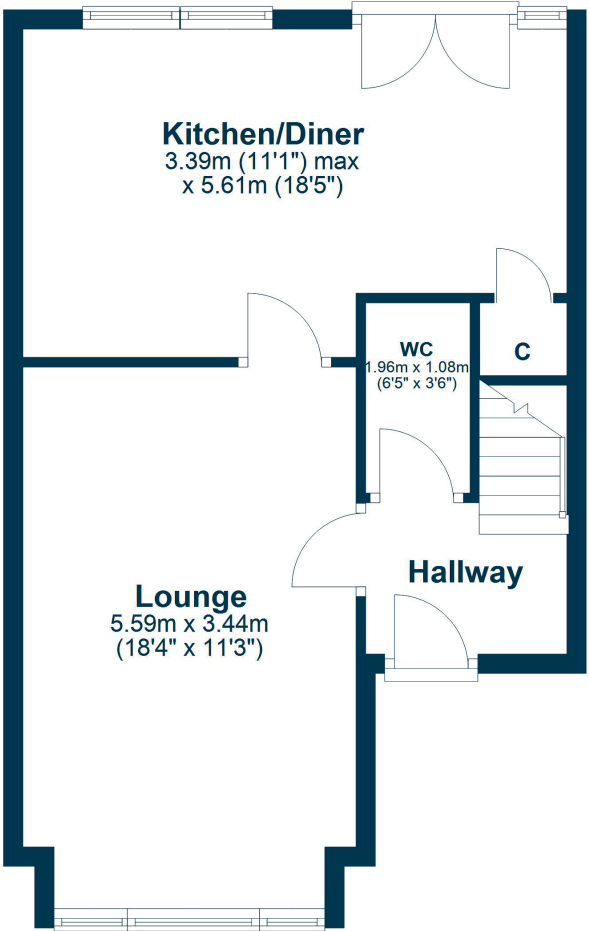

First Floor

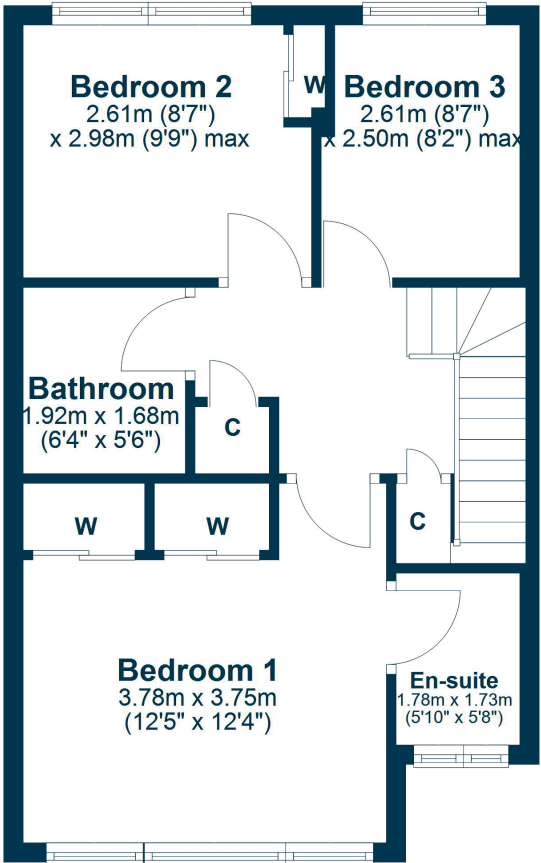

Fairlie is a popular small village located on the Clyde Coast, south of Largs. The village has many amenities which include a primary school, Fairlie Primary, local bar / restaurant, shopping facilities and a bowling club. Fairlie is located within close proximity to Kelburn Country Park and Largs Marina and it is within the catchment area for those who have children attending Largs Academy Campus. The village is also well positioned for accessing all major road networks and there is a local train station which provides a frequent mainline service to Largs and Glasgow.

LA2054 | Sat Nav: 34 Craig Hill Place, Fairlie, KA29 0AY

For the full home report visit [www.corumproperty.co.uk](http://www.corumproperty.co.uk)

\* All measurements and distances are approximate Floorplans are for illustration purposes and may not be to scale.





WE'RE **SOLD** ON  
YOUR FUTURE



Corum Largs  
66 Main Street, Largs, KA30 8AL

**Tel:** 01475 675 001

**Email:** [largs@corumproperty.co.uk](mailto:largs@corumproperty.co.uk)

[www.corumproperty.co.uk](http://www.corumproperty.co.uk)