



1/2, 122 QUEEN'S DRIVE

QUEEN'S PARK

www.corumproperty.co.uk



4 | BEDROOMS
1 | BATHROOM
1 | PUBLIC ROOM

Occupying a bright first floor position opposite Queen’s Park, this terrific four bedroom flat offers generous and flexible accommodation with lovely leafy views.

- Bright first floor flat facing South
- Large hallway with storage
- Impressive lounge with bay window
- Four well proportioned bedrooms
- Kitchen and bathroom
- Gas central heating, neutral decor

Amenities

122 Queen’s Drive is on the doorstep of numerous amenities on Victoria Road or on Pollokshaws Road where thriving coffee houses, restaurants, bakeries and bars can be found. Queen’s Park offers recreational space, tennis courts, football pitches and a regenerated bandstand. Queen’s Park train station is approximately 500 yards away whilst regular bus services are available on Victoria Road or on Pollokshaws Road.

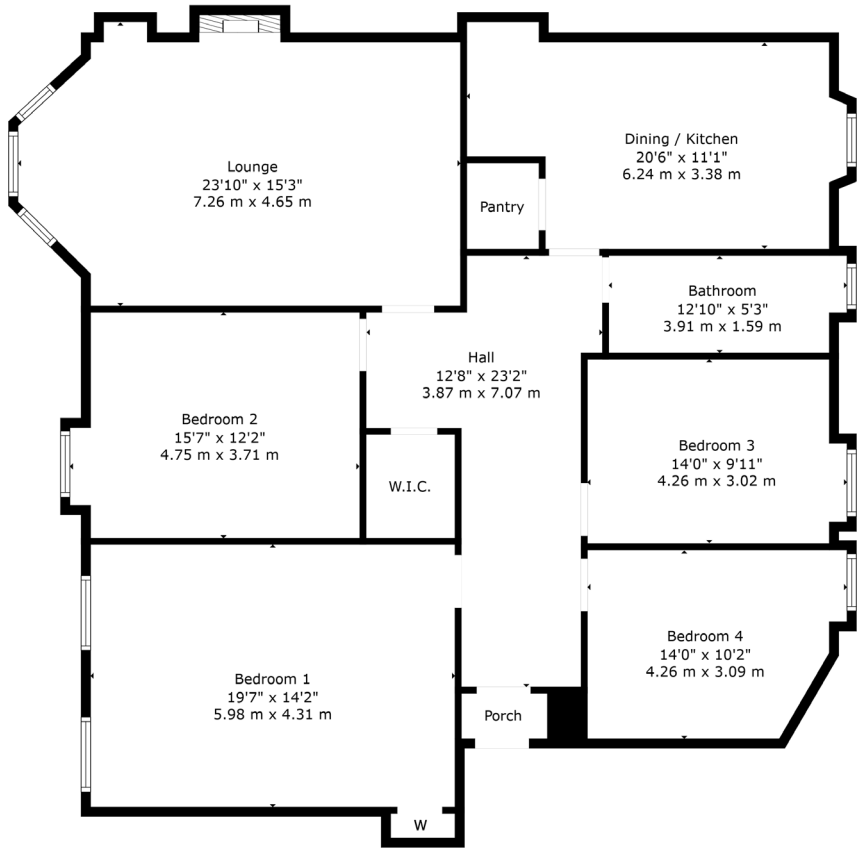

Sat Nav:
122 Queen’s Drive, Glasgow, G42 8QN
SS5026

*All measurements and distances are approximate.
Floorplans are for illustration purposes and may not be to scale.

For the full home report visit
www.corumproperty.co.uk



WE'RE **SOLD** ON
YOUR FUTURE



Corum Shawlands
247 Kilmarnock Road, Shawlands, G41 3JF

Tel: 0141 636 7588

Email: shawlands@corumproperty.co.uk

www.corumproperty.co.uk