



**BEECHGROVE HOUSE**  
FULSHAW WOOD, ST QUIVOX

[www.corumproperty.co.uk](http://www.corumproperty.co.uk)







**4 | BEDROOMS**

**2 | BATHROOMS**

**3 | PUBLIC ROOMS**

**A truly exceptional four bedroom family home located on the fringe of Ayr with incredible elevated country views over rich Ayrshire countryside.**

The unique and special property is located at the end of a private country road and sits in a large plot with extensive wrap around mature gardens. From the house there are spectacular rural aspects to the south over Ayr and beyond.

It is a large home with accommodation that extends to around 2000sq ft sq ft plus a large garage that has been converted to a home office. It would ideally suit the medium size family/professional market or indeed those clients seeking all on the level accommodation within a peaceful yet convenient location.

The generous room sizes accentuate the feeling of space whilst the country views from the kitchen, reception rooms and conservatory lend tranquility to a simply wonderful property. The property has almost immediate access to the A77 trunk road which links to Glasgow and central Scotland. In more detail the accommodation comprises reception hall with two storage cupboards, formal lounge with feature fireplace, separate dining room, large conservatory, modern fitted kitchen, utility/store, four good bedrooms, ( one en suite ), family bathroom, home office, double glazing, oil central heating.

Outside the gardens offer a pleasant mix of soft and hard landscaped areas. There is a tarmac drive to the front which provides hard standing for multiple vehicles. There is a large lawn with extended woodland area, paved pathways, monobloc patio and garden store.























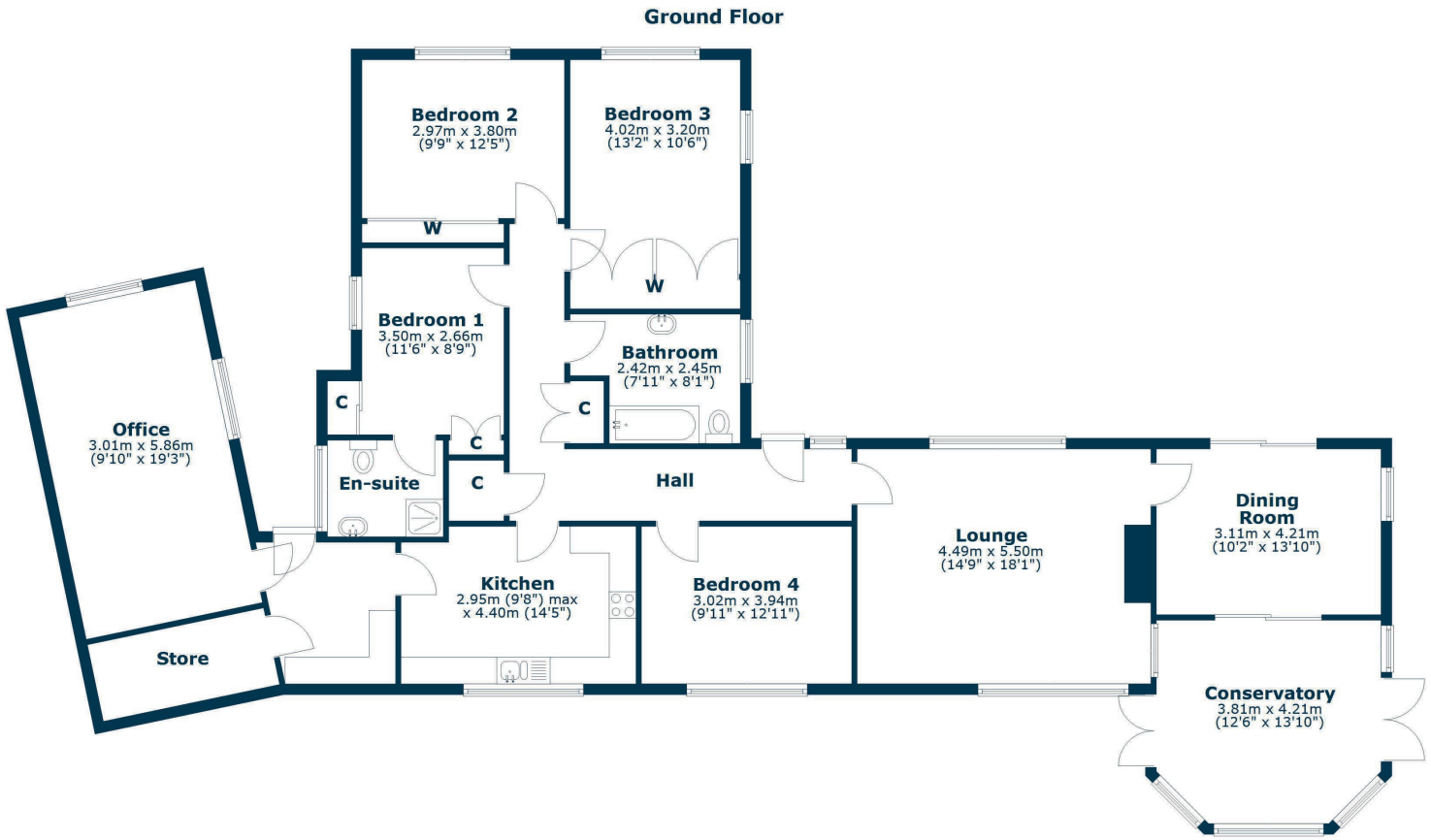

Fulshaw Wood at St Quivox enjoys a stunning semi rural location situated less than a mile from Ayr town centre where you will find a comprehensive range of supermarket and retail shops, cafes, bars, restaurants and recreational facilities.

The nearby A77 provides swift commuting to Kilmarnock, Glasgow and central Scotland. There are main line rail stations at Ayr and Prestwick.

**AY5302** | Sat Nav: Beechgrove House, Fulshaw Wood, St Quivox, KA6 5AA

For the full home report visit [www.corumproperty.co.uk](http://www.corumproperty.co.uk)

\* All measurements and distances are approximate Floorplans are for illustration purposes and may not be to scale.





WE'RE **SOLD** ON  
YOUR FUTURE



Corum Ayr  
10 Beresford Terrace, Ayr, KA7 2EG

**Tel:** 01292 880 888

**Email:** [ayr@corumproperty.co.uk](mailto:ayr@corumproperty.co.uk)

[www.corumproperty.co.uk](http://www.corumproperty.co.uk)