



## FLAT 1C WOODEND

21 MILVERTON ROAD, GIFFNOCK

[www.corumproperty.co.uk](http://www.corumproperty.co.uk)







3 | BEDROOMS

2 | BATHROOMS

2 | PUBLIC ROOMS

**A larger style first floor apartment set within this admired, private development amidst beautiful residents' gardens.**

One of Dickie the Builders original landmark developments and set within beautiful residents' garden grounds that are both established and private, Corum are delighted to present to the market this extremely spacious first floor apartment that has its own private south facing balcony and delivers outstanding floor space and storage. Stunning residents' entrance area, elevator access and the flat has access to residents' parking and private lock up garage.

The accommodation extends to large reception hallway with particularly generous storage provided, a superb sized dual aspect lounge with doors to south facing balcony, formal dining room, recently upgraded dining sized kitchen with full range of Neff integrated appliances, principal bedroom with extensive storage and en-suite bathroom, two further double bedrooms (one used as a TV room), and an additional upgraded shower room with tiling completes the accommodation. The property has a system of gas central heating with recently upgraded Worcester boiler (2023) and there is a security alarm system.

In addition to the outstanding lawned residents' gardens there is ample seating areas for enjoying a summer's day and socialising with the residents. The external gardens are illuminated in the evening and provide privacy, seclusion and a lovely place to enjoy the surroundings.







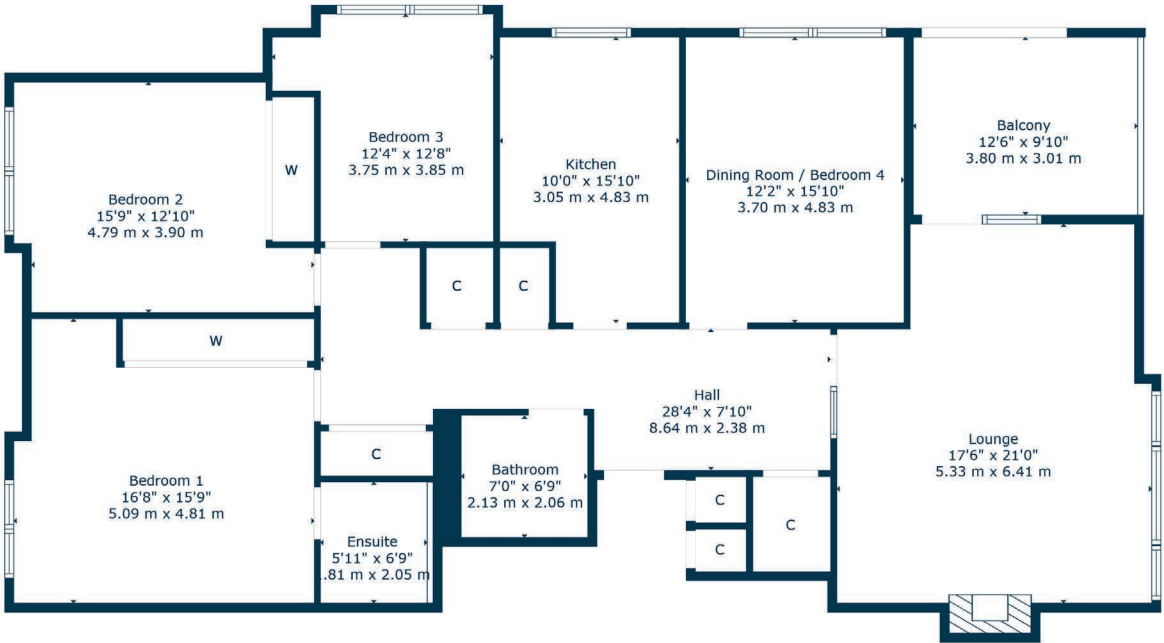
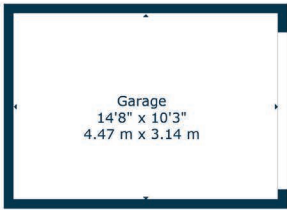

Giffnock continues to be one of the most desirable residential suburbs on Glasgow's south side. A haven for young growing families, the district is synonymous with some of the best schooling in the West of Scotland. Moreover, there are excellent transport links via bus and train close at hand, in addition to local motorway links (M77/M8) providing swift access to the city centre and Ayrshire. There are two train stations within close proximity, Giffnock Train Station and Whitecraigs Train Station. There are numerous independent shops, restaurants and delicatessens only a short walk away. An abundance of sports and leisure facilities are available within East Renfrewshire including PureGym, David Lloyd Sports Club, Nuffield Health Gym, Whitecraigs Golf Club, Giffnock and Whitecraigs Tennis Clubs and Rouken Glen Park which was voted UK's Best Park of 2016.

**NM4598** | Sat Nav: Flat 1C Woodend, 21 Milverton Road, Giffnock, G46 7JN

For the full home report visit [www.corumproperty.co.uk](http://www.corumproperty.co.uk)

\* All measurements and distances are approximate Floorplans are for illustration purposes and may not be to scale.





WE'RE **SOLD** ON  
YOUR FUTURE



Corum Newton Mearns  
134 Ayr Road, Newton Mearns, G77 6EG

**Tel:** 0141 639 5888

**Email:** [n.mearns@corumproperty.co.uk](mailto:n.mearns@corumproperty.co.uk)

[www.corumproperty.co.uk](http://www.corumproperty.co.uk)