



1 WOODLEA PLACE

AYR

www.corumproperty.co.uk





4 | BEDROOMS

2 | BATHROOMS

2 | PUBLIC ROOMS

An impressive detached family home set on a substantial corner plot in Alloway, with generous garden grounds, well-proportioned modern accommodation and a detached garage.

Woodlea Place is an exclusive and sought-after address in Alloway, conveniently positioned adjacent to Maybole Road for public transport and various local amenities. Number 1 is a six apartment detached family villa that sits on a large corner plot, with a south facing aspect at the side and an open outlook at the front. There are fantastic spacious living spaces and flexible bedrooms that will suit a range of buyers. There is a detached garage, ample off road parking and early viewing is essential.

In more detail, the internal accommodation extends to an entrance porch leading into a hallway, with stairs leading to the upper floor, a downstairs shower room, a downstairs bedroom with fitted wardrobes, a large lounge with a feature fireplace, a modern kitchen with a door out to the garden, and a formal dining room. On the upper floor there are three large double bedrooms, all with fitted wardrobe space, a fully tiled family bathroom and loft access.

Externally there are generous gardens that wrap around the property and extend across a prime corner plot, with a monoblock driveway. There is a garage at the side and gated access round to a fully enclosed rear garden, with lawn and decorative shrubs.







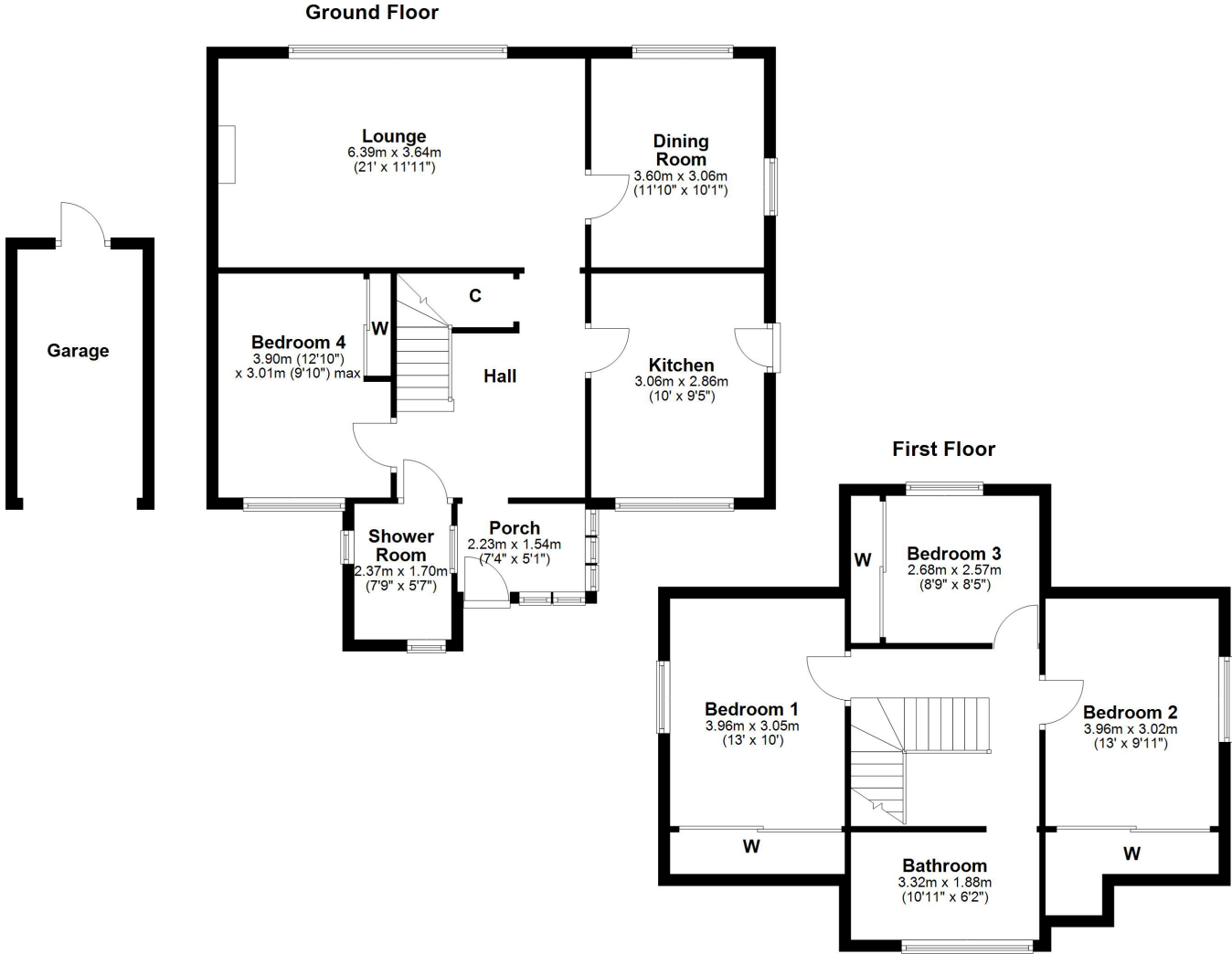

Woodlea Place is a first class residential area quietly located within Alloway. A good range of local amenities are within a very short distance on Maybole Road, whilst Ayr town centre is approximately one mile distant. Maybole Road leads directly onto the A77 bypass for swift commuting to Glasgow and surrounding districts.

AY5336 | Sat Nav: 1 Woodlea Place, Ayr, KA7 4TA

For the full home report visit www.corumproperty.co.uk

* All measurements and distances are approximate Floorplans are for illustration purposes and may not be to scale.

WE'RE **SOLD** ON
YOUR FUTURE



Corum Ayr
10 Beresford Terrace, Ayr, KA7 2EG

Tel: 01292 880 888

Email: ayr@corumproperty.co.uk

www.corumproperty.co.uk