



FLAT 0/2, 24 ST. NINIAN TERRACE

GLASGOW

www.corumproperty.co.uk



2 | BEDROOMS
1 | BATHROOM
1 | PUBLIC ROOM

Spacious two bedroom flat in a central location close to City centre and the Southside featuring private gardens and residents parking.

- Modern apartment set within a popular residential development.
- Private gardens with direct access.
- Two bedrooms.
- Ground floor.
- Central location with excellent amenities.
- Well presented throughout.

Amenities

The property is positioned within walking distance of shops and amenities upon Crown Street approximately 100 yards walk to the South West. Local butcher, baker and Co-Op should satisfy most day to day needs. The area is well served by way of recreational pursuits, the Citizen’s Rose Garden a short walk to the West, the New Gorbals Rose Garden a short walk directly South. The property is located directly opposite the Gorbals Glasgow Club whist Glasgow Green and the Peoples Palace are literally just over the bridge approximately five minutes’ to the North East. Frequent public transport services provide rapid commuter access to the city centre. The city centre itself is actually a five/ eight minute brisk walk.

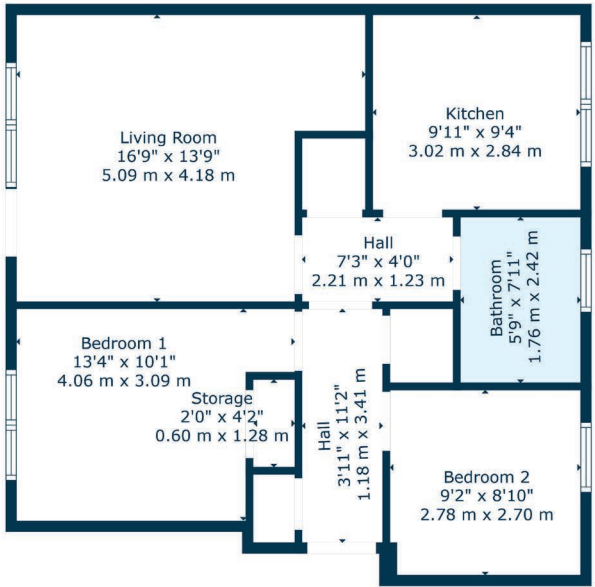

Sat Nav:
Flat 0/2, 24 St. Ninian Terrace, Glasgow G5 0RJ

NM4625

*All measurements and distances are approximate.
Floorplans are for illustration purposes and may not be to scale.

For the full home report visit
www.corumproperty.co.uk



WE'RE **SOLD** ON
YOUR FUTURE



Corum Newton Mearns
134 Ayr Road, Newton Mearns, G77 6EG

Tel: 0141 639 5888

Email: n.mearns@corumproperty.co.uk

www.corumproperty.co.uk