



2/1, 107 ALBERT ROAD
CROSSHILL

www.corumproperty.co.uk



2 | BEDROOMS
1 | BATHROOM
1 | PUBLIC ROOM

A generously proportioned second floor flat set within an attractive tenement with communal gardens to rear and presented in superb order throughout.

- Second floor flat
- 2 double bedrooms, modern bathroom
- Impressive lounge with bay window
- Dining sized kitchen with modern range of units
- Squash court flooring in kitchen
- Gas central heating, double glazing, secure entry system

Amenities

The property is positioned within walking distance of shops and amenities upon Victoria Road, Pollokshaws Road and Kilmarnock Road, where thriving coffee shops, bars, restaurants and delicatessens can be found. Nearby you can find large supermarkets and other amenities such as Marks and Spencer's store at Queens Park, Aldi store at Crown Street Retail Park, the Morrison's store at Crossmyloof, Asda at Toryglen, or the shopping mall at Silverburn Pollok, a short drive to the South West.

Recreational pursuits are varied in nearby Queen's Park which has nature walks/trails, all-weather football pitches and tennis courts. Frequent public transport provides rapid commuter access to the city centre. The local railway station at Crosshill is within 2-minute walk from the flat.

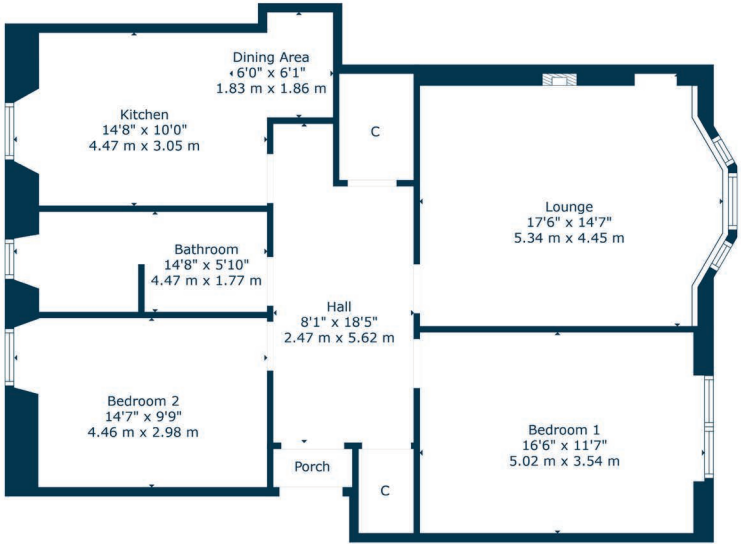

Sat Nav:
2/1, 107 Albert Road, Crosshill, Glasgow, G42 8DP

SS5078

*All measurements and distances are approximate.
Floorplans are for illustration purposes and may not be to scale.

For the full home report visit
www.corumproperty.co.uk



WE'RE **SOLD** ON
YOUR FUTURE



Corum Shawlands
247 Kilmarnock Road, Shawlands, G41 3JF

Tel: 0141 636 7588

Email: shawlands@corumproperty.co.uk

www.corumproperty.co.uk