



63 HECTOR ROAD

SHAWLANDS

www.corumproperty.co.uk



2 | BEDROOMS
1 | BATHROOM
1 | PUBLIC ROOM

This unique main door home is found in a purpose built tenement building on Hector Road, a central Shawlands address. The property was adapted some years ago to create two bedrooms so whilst the footprint is unusual, it works very well. This is a terrific opportunity to live on the doorstep of all that Shawlands has to offer.

- Main door flat in centre of Shawlands
- Bay windowed lounge to front
- Two generous double bedrooms
- Fresh three piece bathroom suite
- Private Southerly facing front garden
- Gas central heating & double glazing

Amenities

63 Hector Road is in close proximity to shops, bars, coffee houses, bakeries and restaurants. Sainsburys, Tesco, Co-op and M&S stores are all within half a mile of the property. Pollok Park and Queen’s Park both have excellent recreational space whilst Shawlands Civic Square is also nearby, designed to offer a destination for markets, dance, craft events, speakers and debate.

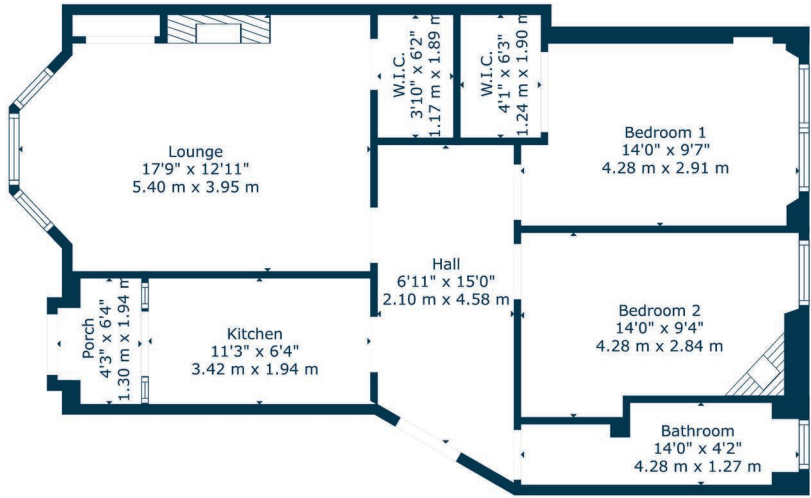

Sat Nav:
63 Hector Road, Shawlands, G41 3QD

SS5089

*All measurements and distances are approximate.
Floorplans are for illustration purposes and may not be to scale.

For the full home report visit
www.corumproperty.co.uk



WE'RE **SOLD** ON
YOUR FUTURE



Corum Shawlands
247 Kilmarnock Road, Shawlands, G41 3JF

Tel: 0141 636 7588

Email: shawlands@corumproperty.co.uk

www.corumproperty.co.uk