



GROUND FLOOR, 20 MARYWOOD SQUARE

STRATHBUNGO

www.corumproperty.co.uk



2 | BEDROOMS
1 | BATHROOM
1 | PUBLIC ROOM

A spacious 2 bedroom ground floor conversion of an attractive stone fronted townhouse, which is presented to the market in great order.

- Residents’ vestibule and lobby
- Superb bay windowed lounge
- Modern fitted kitchen
- 2 significant double bedrooms
- Modern fitted bathroom
- Communal rear gardens and parking

Amenities

The property is positioned within walking distance of shops and amenities upon Pollokshaws Road and within central Strathbungo where thriving coffee shops, restaurants and delicatessens can be found. Marks and Spencer’s store at Queens Park, Sainsbury’s Local on Darnley Road, the Morrisons store at Crossmyloof, Newlands or Giffnock are also all nearby. The Avenue shopping mall in Newton Mearns and the shopping mall at Silverburn Pollok which is a short drive to the South West. Recreational pursuits are varied in nearby Queen’s Park where nature walks/trails, all-weather football pitches and tennis courts. Frequent public transport provides rapid commuter access to the city centre. The local railway station is approximately 200 yards walk.

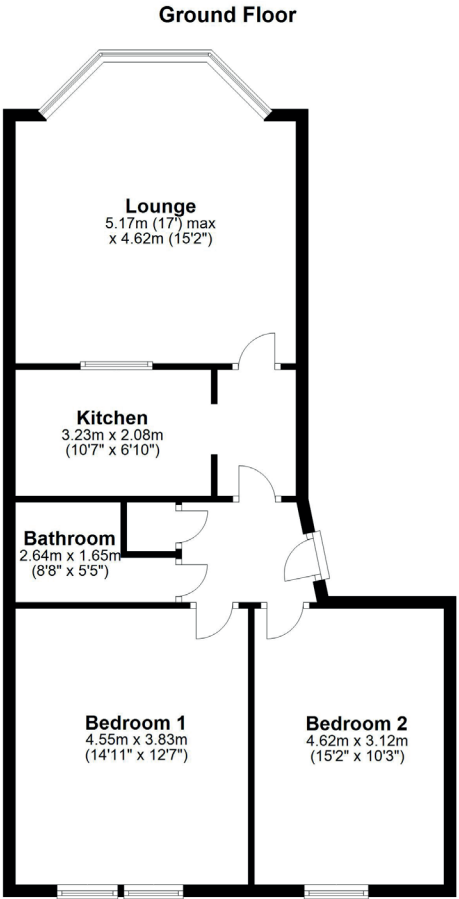

Sat Nav:
Ground Floor, 20 Marywood Square, Strathbungo, G41 2BJ

SS5099

*All measurements and distances are approximate.
Floorplans are for illustration purposes and may not be to scale.

For the full home report visit
www.corumproperty.co.uk



WE'RE **SOLD** ON
YOUR FUTURE



Corum Shawlands
247 Kilmarnock Road, Shawlands, G41 3JF

Tel: 0141 636 7588

Email: shawlands@corumproperty.co.uk

www.corumproperty.co.uk