



**4/2 15 CASTLEBANK PLACE**  
GLASGOW HARBOUR

[www.corumproperty.co.uk](http://www.corumproperty.co.uk)







**2 | BEDROOMS**

**2 | BATHROOMS**

**1 | PUBLIC ROOM**

**4/2 15 Castlebank Place is a fantastic, spacious, two bedroom modern flat with underground allocated parking and balcony, with wonderful views of the River Clyde.**

The property is initially accessed via a secure door entry system, with stair and lift access to all levels, and underground parking where the flat has exclusive use of an allocated space. The internal accommodation comprises; a welcoming reception hallway with storage cupboard and main bathroom off, and a bright and spacious open-plan lounge/kitchen with ample space for dining and a private balcony, perfect for those summer months. There are two double bedrooms, both with wardrobe space, the principal with a walk-in style, and it benefits from an en-suite shower room.

The property also benefits from gas central heating, a secure entry system, utility room, allocated underground parking and a communal courtyard. Situated right on the banks of the River Clyde, there is perfect opportunity to walk along the Broomielaw into the City Centre and the iconic landmarks, including SEC Armadillo and The OVO Hydro.





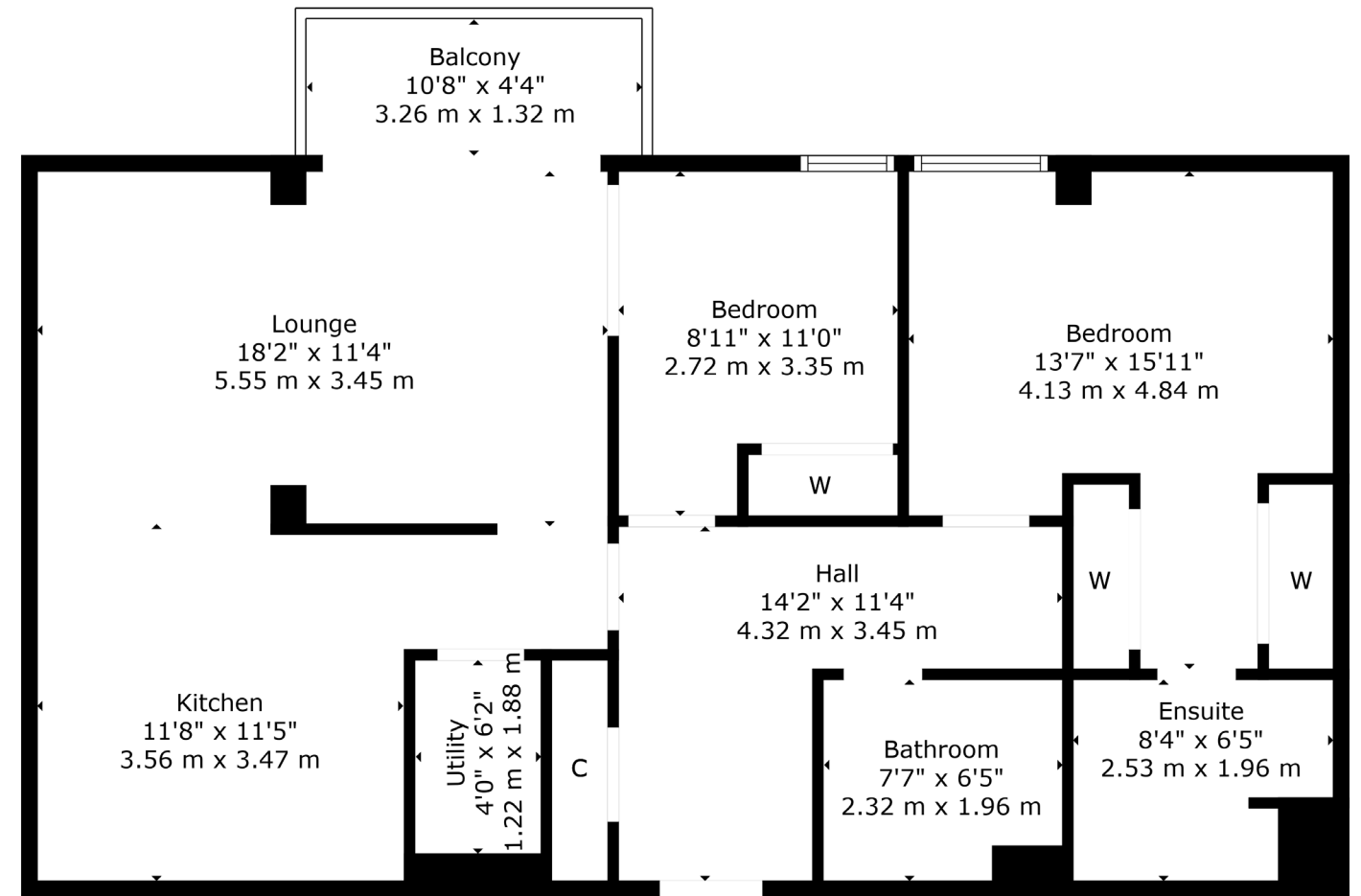

Glasgow Harbour is well placed for local amenities on Dumbarton Road and Crow Road, including shops, cafés, bars and restaurants. There are also a number of national retailers, including Marks & Spencer, Sainsburys, and Boots. Popular Byres Road offers a further selection of shops and amenities, including cafés, bars and restaurants. Here, there is also a Waitrose and a cinema.

Public transport is available by rail and underground from Partick Station and a bus service operates on Dumbarton Road. There is good access to the Clydeside Expressway and the Clyde Tunnel.

The property is also well placed for access to a number of major employers, including the BBC, STV, Glasgow University and several hospitals.

**WE5373** | Sat Nav: 15 Castlebank Place, Glasgow Harbour, Glasgow, G11 6BJ

For the full home report visit [www.corumproperty.co.uk](http://www.corumproperty.co.uk)

\* All measurements and distances are approximate Floorplans are for illustration purposes and may not be to scale.





WE'RE **SOLD** ON  
YOUR FUTURE



Corum West End  
82 Hyndland Road, Glasgow, G12 9UT

**Tel:** 0141 357 1888

**Email:** [westendenq@corumproperty.co.uk](mailto:westendenq@corumproperty.co.uk)

[www.corumproperty.co.uk](http://www.corumproperty.co.uk)