



1/1, 71 WAVERLEY STREET

SHAWLANDS

www.corumproperty.co.uk



2 | BEDROOMS
1 | BATHROOM
1 | PUBLIC ROOM

This first floor home is found in a purpose built tenement building in Waverley Street, a very popular Shawlands address. The property has been cared and enjoyed by our clients and it represents a terrific opportunity to live in a thriving part of Glasgow's Southside.

- First floor flat in centre of Shawlands
- Bay lounge open plan to fitted kitchen
- Two double sized bedrooms
- Tasteful décor and flooring
- Gas heating & double glazed windows
- Superb location, amenities & transport

Amenities

71 Waverley Street is in close proximity to numerous shops, bars, coffee houses, bakeries and restaurants in Shawlands and Strathbungo. Sainsburys, Tesco, Co-op and M&S stores are all within one mile of the property. Queen's Park and Pollok Park both have excellent recreational space and Shawlands Civic Square is also nearby, designed to offer a destination for markets, dance, craft events, speakers and debate.

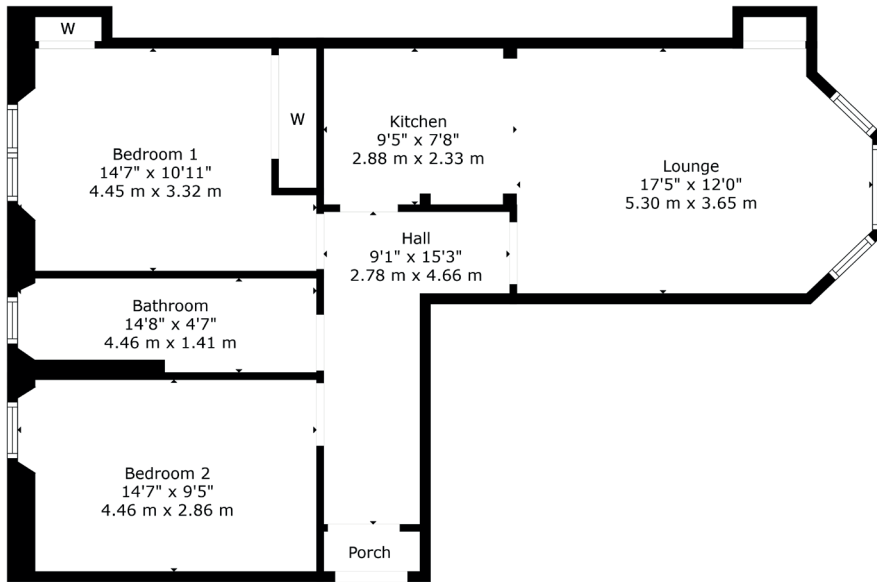

Sat Nav:
71 Waverley Street, Shawlands, G41 2DY

SS5104

*All measurements and distances are approximate.
Floorplans are for illustration purposes and may not be to scale.

For the full home report visit
www.corumproperty.co.uk



WE'RE **SOLD** ON
YOUR FUTURE



Corum Shawlands
247 Kilmarnock Road, Shawlands, G41 3JF

Tel: 0141 636 7588

Email: shawlands@corumproperty.co.uk

www.corumproperty.co.uk