



2/1, 1 RIVERFORD GARDENS

SHAWLANDS

www.corumproperty.co.uk



2 | BEDROOMS
2 | BATHROOMS
1 | PUBLIC ROOM

Occupying a bright second floor position in an admired collection of homes this is a wonderful example of a two-bedroom apartment. Riverford Gardens is a very trendy place to live given its quiet cul-de-sac setting and its proximity to countless attractions throughout the Southside.

- Modern apartment in peaceful address
- Open plan living dining kitchen
- Southerly facing private balcony
- Two double sized bedrooms
- Bathroom & en-suite shower
- One designated parking space

Amenities

1 Riverford Gardens is in close proximity to thriving shops, bars, coffee houses and restaurants in Shawlands and Pollokshaws. Both Pollok Park and Newlands Park are within half a mile of the front door both offering exceptional recreational space. Lidl and Morrisons stores are literally around the corner whilst bus routes and train stations are available within half a mile of the property.

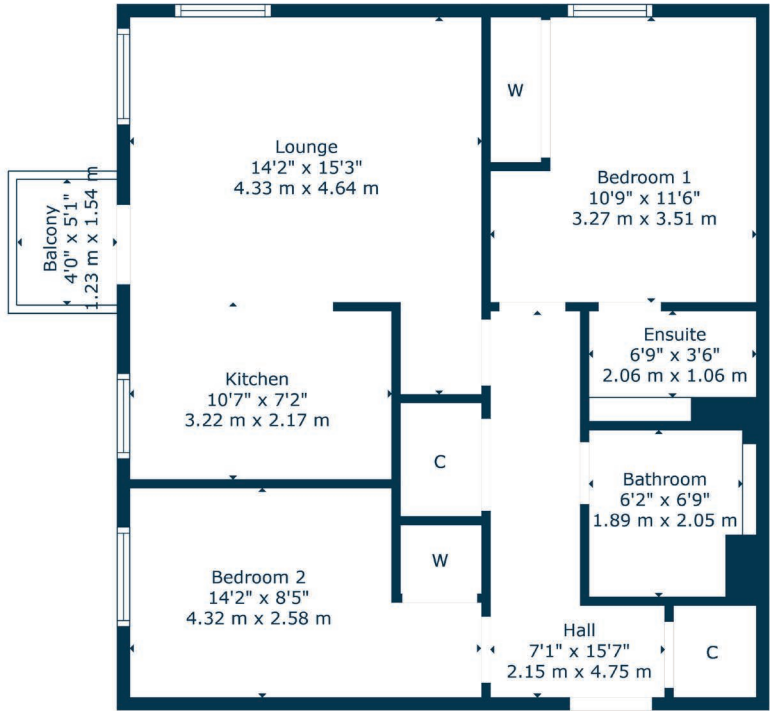

Sat Nav:
2/1, 1 Riverford Gardens, Shawlands, G43 1ET

SS5119

*All measurements and distances are approximate. Floorplans are for illustration purposes and may not be to scale.

For the full home report visit
www.corumproperty.co.uk



WE'RE **SOLD** ON
YOUR FUTURE



Corum Shawlands
247 Kilmarnock Road, Shawlands, G41 3JF

Tel: 0141 636 7588

Email: shawlands@corumproperty.co.uk

www.corumproperty.co.uk