



11 FOXFIELD DRIVE

SYMINGTON

www.corumproperty.co.uk





3 | BEDROOMS

2 | BATHROOMS

1 | PUBLIC ROOM

A stunning family home set within an executive development in Symington, with south-facing landscaped gardens, quality fittings, private parking and offering flexible luxury accommodation that will suit a range of buyers.

11 Foxfield Drive is an excellent example of a spacious terraced family villa set in the popular village of Symington, with private gardens and a gorgeous open outlook to the front over public green space. This home is presented to the market in truly showhome condition, with immaculate modern fixtures and fittings throughout, quality floor coverings and spacious flexible accommodation. There are enclosed landscaped south-facing garden grounds, off road parking and the property will appeal to a range of buyers, including the family market.

In more detail, the internal accommodation extends to an entrance hall with a downstairs W.C, a large and bright lounge with stairs leading to the upper apartments, and a fitted dining kitchen with French doors leading into the garden, integral appliances, a breakfast bar and space for dining or a family area. On the upper floor there is a spacious master bedroom with fitted wardrobes and an en suite shower room, a storage cupboard off the landing, loft access, a family bathroom suite and two further bedrooms, including one with fitted wardrobes.

Externally there is a monoblock driveway to the front allowing off road parking, decorative trees and lawn. The rear garden is fully enclosed with a paved patio and artificial turf. There is also gated access for bins to the rear.







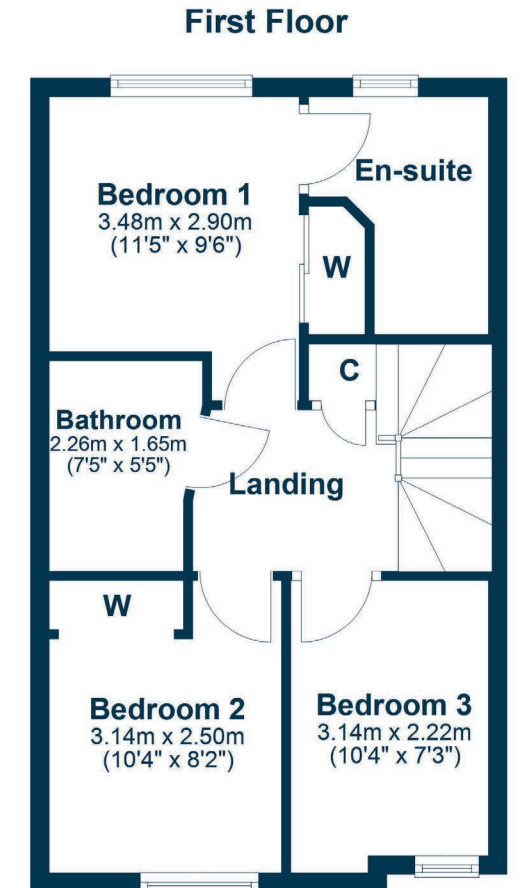
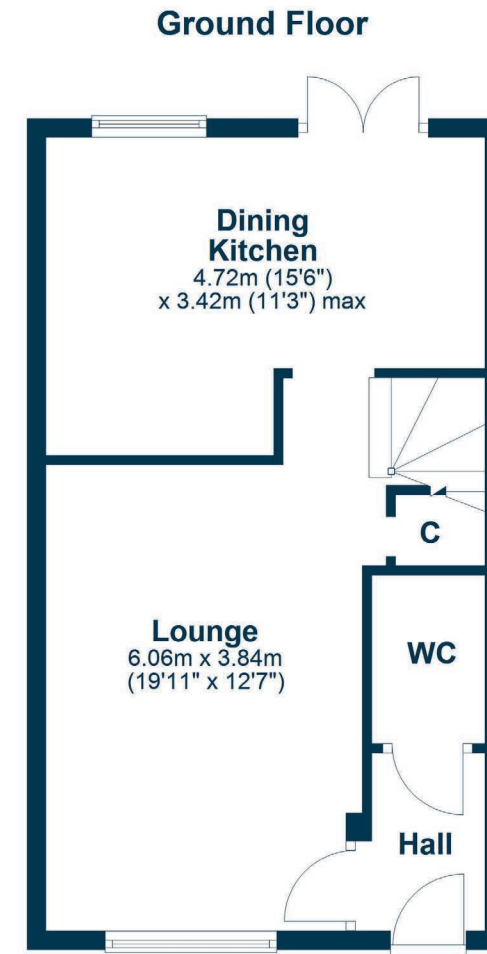

Symington is a delightful village close to the A77/M77 linking to both Glasgow and Ayr and around 5 miles from the coastal town of Troon. The village itself provides a range of amenities including various shops, a post office, The Wheatsheaf restaurant/bar and an excellent primary school. Prestwick International Airport, with regular flights to destinations throughout Europe is around 5 miles distant and South Ayrshire boasts a range of championship golf courses.

TR2039 | Sat Nav: 11 Foxfield Drive, Symington, KA1 5SD

For the full home report visit www.corumproperty.co.uk

* All measurements and distances are approximate Floorplans are for illustration purposes and may not be to scale.



WE'RE **SOLD** ON
YOUR FUTURE



Corum Troon
29 Portland Street, Troon, KA10 6AA

Tel: 01292 310 010

Email: troon@corumproperty.co.uk

www.corumproperty.co.uk