



**2/3 23 KENLEY ROAD**  
RENFREW

[www.corumproperty.co.uk](http://www.corumproperty.co.uk)







2 | BEDROOMS

2 | BATHROOMS

1 | PUBLIC ROOM

**Stylish modern two bedroom apartment in the popular Ferry Village development convenient for the numerous amenities of Braehead shopping centre.**

An attractive modern apartment positioned in this vibrant area of Renfrew adjacent to the southern banks of the River Clyde. A convenient location to access the varied retail and leisure facilities of Braehead Shopping Centre and with excellent connections for commuters to the M8 motorway and the recently opened Renfrew Bridge.

A well presented modern home that occupies a bright second floor position in the building. The specification include a good quality fitted kitchen with appliances and attractive sanitary ware in both the bathroom and ensuite shower room. There is double glazing, gas fired central heating, a security entry system and communal residents parking in the landscaped grounds.

The accommodation comprises of an L-shaped reception hallway with two storage cupboards and access to all rooms. The lounge is a lovely room with twin French doors to a Parisian balcony and an open plan layout to the fitted kitchen. The principal double bedroom has fitted wardrobes and a tiled ensuite shower room. There is a second bedroom with wardrobe storage and a spacious main bathroom.







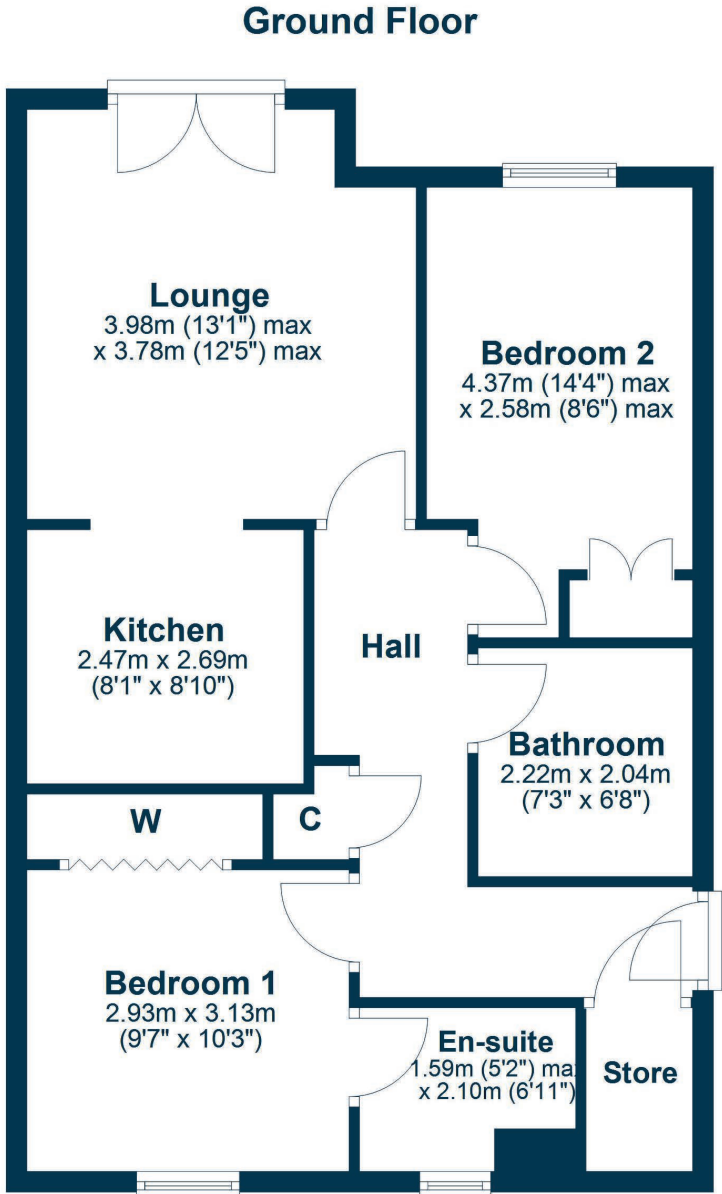

**BW2722** | Sat Nav: 2/3 23 Kenley Road, Renfrew, PA4 8FF

For the full home report visit [www.corumproperty.co.uk](http://www.corumproperty.co.uk)

\* All measurements and distances are approximate Floorplans are for illustration purposes and may not be to scale.





WE'RE **SOLD** ON  
YOUR FUTURE



Corum Bridge of Weir  
2 Windsor Place, Main Street, Bridge Of Weir, PA11 3AF

T: 01505 691 400

E: [bridgeofweir@corumproperty.co.uk](mailto:bridgeofweir@corumproperty.co.uk)

[www.corumproperty.co.uk](http://www.corumproperty.co.uk)