



**2/2, 277 ALBERT DRIVE**

**POLLOKSHIELDS**

[www.corumproperty.co.uk](http://www.corumproperty.co.uk)



4 | BEDROOMS  
1 | BATHROOM  
1 | PUBLIC ROOM

An impressive and generously proportioned second floor flat, presented to the market in great condition and set within central Pollokshields.

- Impressive second floor flat
- Huge hallway and excellent storage
- 4 double sized bedrooms
- Bay window lounge with views
- Dining kitchen with utility and pantry off
- Gas central heating, communal gardens

Amenities

277 Albert Drive is positioned within walking distance of a broad range of shops and amenities upon Nithsdale Road/Kildrostan Street, where coffee shops, restaurants and delicatessens are available. More extensive amenities can be found at the Morrisons’ store at Crossmyloof or the Silverburn shopping mall at Pollok, a short drive to the West.

Recreational pursuits within the area are varied namely at Maxwell Park or Pollok Park where nature walks/trails, Pollok House and the world famous Burrell Collection can be found.

Frequent public transport services provide rapid commuter access to the city centre, the local railway station is a short distance away, whilst Shields Road underground station is also a short walk away.

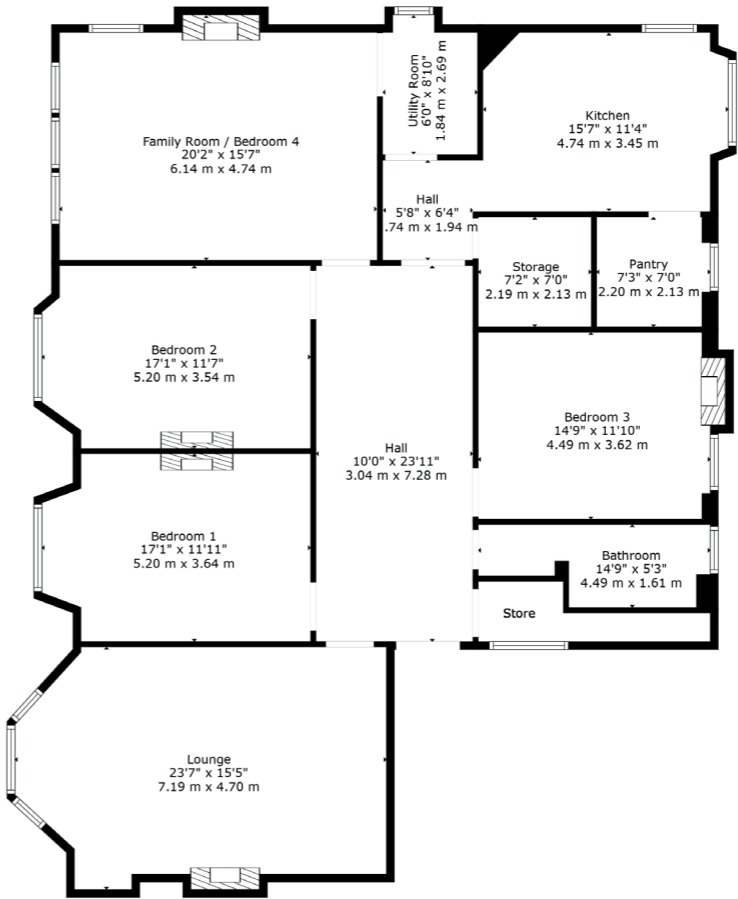

Sat Nav:  
277 Albert Drive, Pollokshields, G41 2RN

SS5128

\*All measurements and distances are approximate.  
Floorplans are for illustration purposes and may not be to scale.

For the full home report visit  
[www.corumproperty.co.uk](http://www.corumproperty.co.uk)



WE'RE **SOLD** ON  
YOUR FUTURE



Corum Shawlands  
247 Kilmarnock Road, Shawlands, G41 3JF

Tel: 0141 636 7588

Email: [shawlands@corumproperty.co.uk](mailto:shawlands@corumproperty.co.uk)

[www.corumproperty.co.uk](http://www.corumproperty.co.uk)