



**1/1, 21 CARTHA STREET**  
SHAWLANDS

[www.corumproperty.co.uk](http://www.corumproperty.co.uk)



2 | BEDROOMS  
1 | BATHROOM  
1 | PUBLIC ROOM

Occupying a bright first floor position in an attractive red sandstone building, this two bedroom flat offers a modern specification and open aspects to the front.

- First floor flat on the doorstep of Shawlands amenities
- Bay windowed lounge with focal fireplace
- Two generous double bedrooms and modern bathroom
- Modern fitted kitchen, original features
- Double glazing, gas central heating, secure entry system

Amenities

21 Cartha Street is in close proximity to thriving shops, bars, coffee houses, bakeries and restaurants. A Morrisons, a Sainsburys, a Tesco and an M&S store are within one mile of the property. Queens Park boasts recreational space, tennis courts and football pitches, whilst Shawlands Civic Square is also nearby, designed to offer a destination for markets, dance, craft events, speakers and debate.

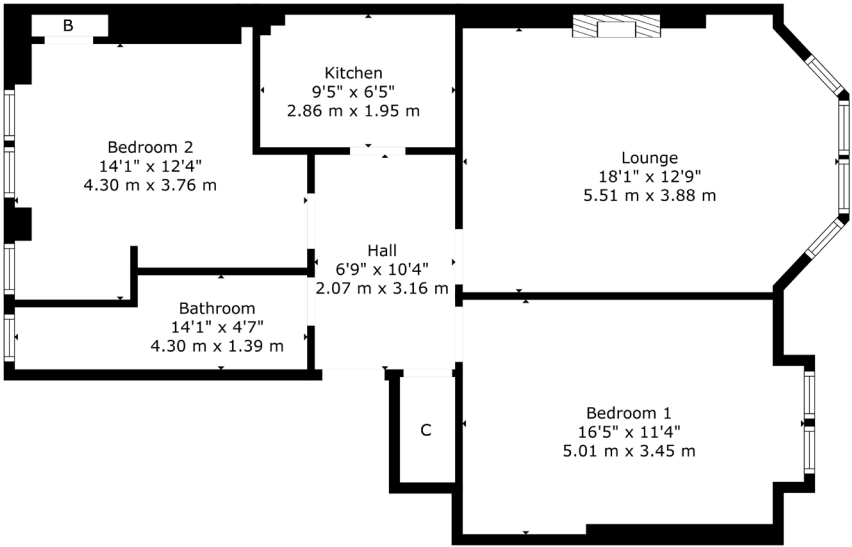

Sat Nav:  
21 Cartha Street, Shawlands, G41 3HH

SS5134

\*All measurements and distances are approximate.  
Floorplans are for illustration purposes and may not be to scale.

For the full home report visit  
[www.corumproperty.co.uk](http://www.corumproperty.co.uk)





WE'RE **SOLD** ON  
YOUR FUTURE



Corum Shawlands  
247 Kilmarnock Road, Shawlands, G41 3JF

**Tel:** 0141 636 7588

**Email:** shawlands@corumproperty.co.uk

[www.corumproperty.co.uk](http://www.corumproperty.co.uk)