



**3/2, 14 HAGGS GATE**

POLLOKSHIELDS

[www.corumproperty.co.uk](http://www.corumproperty.co.uk)





2 | BEDROOMS  
2 | BATHROOMS  
1 | PUBLIC ROOM

An impressive 2 bedroom third floor flat within the 'Park Grove' development by Westpoint homes overlooking Pollok Park to the West.

- Private parking, lift access
- Large lounge/dining open plan kitchen living space
- 2 double bedrooms
- Full width roof terrace overlooking the park
- Dedicated utility, bedroom 1 en-suite, separate main bathroom
- Gas central heating, double glazing, secure entry system
- Private access to Pollok Park

Amenities

The property is positioned within walking distance of shops and amenities in central Shawlands where thriving coffee shops, restaurants and delicatessens can be found more extensive amenities are available at the Marks and Spencer's at Queens Park, Morrisons store at Crossmyloof or Newlands, the shopping mall at Silverburn is a short drive to the West. Recreational pursuits are varied mainly at Clydesdale cricket ground, Maxwell Park, Pollok Country Park where Pollok House and the world famous Burrell collection can be found, also Bellahouston Ski & Sports Centre.

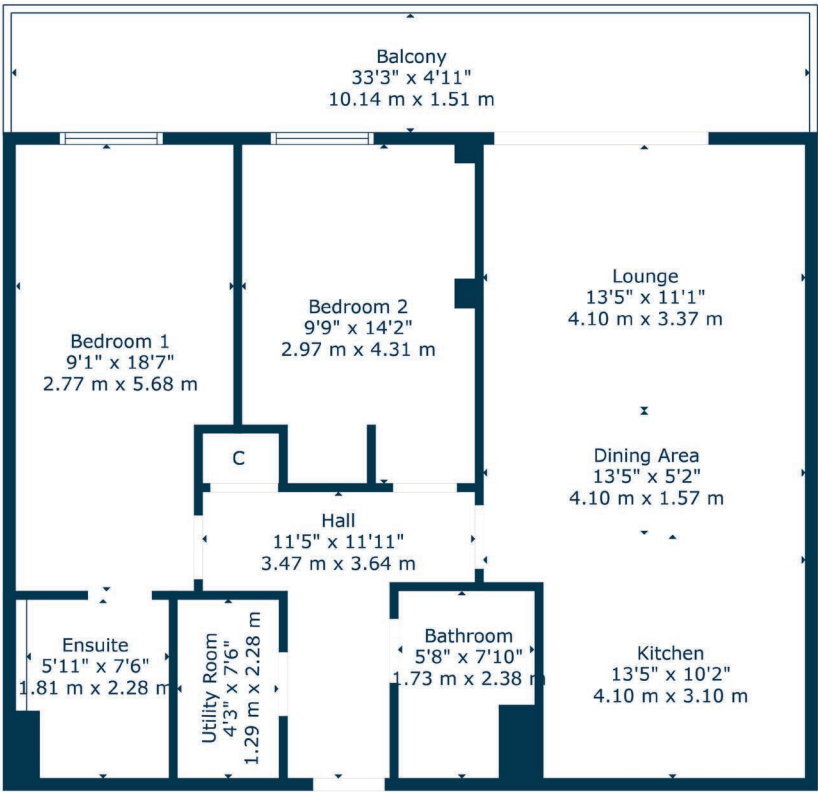

Sat Nav:  
3/2, 14 Haggis Gate, Pollokshields, G41 4BE

SS5149

\*All measurements and distances are approximate.  
Floorplans are for illustration purposes and may not be to scale.

For the full home report visit  
[www.corumproperty.co.uk](http://www.corumproperty.co.uk)





WE'RE **SOLD** ON  
YOUR FUTURE



Corum Shawlands  
247 Kilmarnock Road, Shawlands, G41 3JF

**Tel:** 0141 636 7588

**Email:** [shawlands@corumproperty.co.uk](mailto:shawlands@corumproperty.co.uk)

[www.corumproperty.co.uk](http://www.corumproperty.co.uk)