



123 NORSE ROAD

SCOTSTOUN

www.corumproperty.co.uk





4 | BEDROOMS

1 | BATHROOM

2 | PUBLIC ROOMS

Located on the ever-popular Norse Road in the heart of Scotstoun, this substantial red sandstone mid terrace villa offers a rare opportunity to acquire a family home with immense potential. One of the most appealing aspects about the area is Scotstoun Primary School, that has recently been voted as number one Primary in Glasgow and number four nationally (2025 Sunday Times Primary School League Table).

Retaining many original features and boasting generous proportions throughout, the property is set within established gardens, including a desirable south-facing rear garden. Internally, the ground floor comprises a bright and spacious bay-windowed living room to the front, a formal dining room overlooking the rear garden, and a well-proportioned kitchen with an adjoining pantry. There is also a convenient downstairs WC located off the hall. Upstairs, the accommodation extends to four bedrooms—three well-sized doubles and a single—along with a family bathroom.

Externally, the property benefits from a detached garage, and the south-facing rear garden is particularly attractive, providing a private and sunny outdoor space ideal for families or keen gardeners.

While the house requires a degree of modernisation, it is a truly special family home.







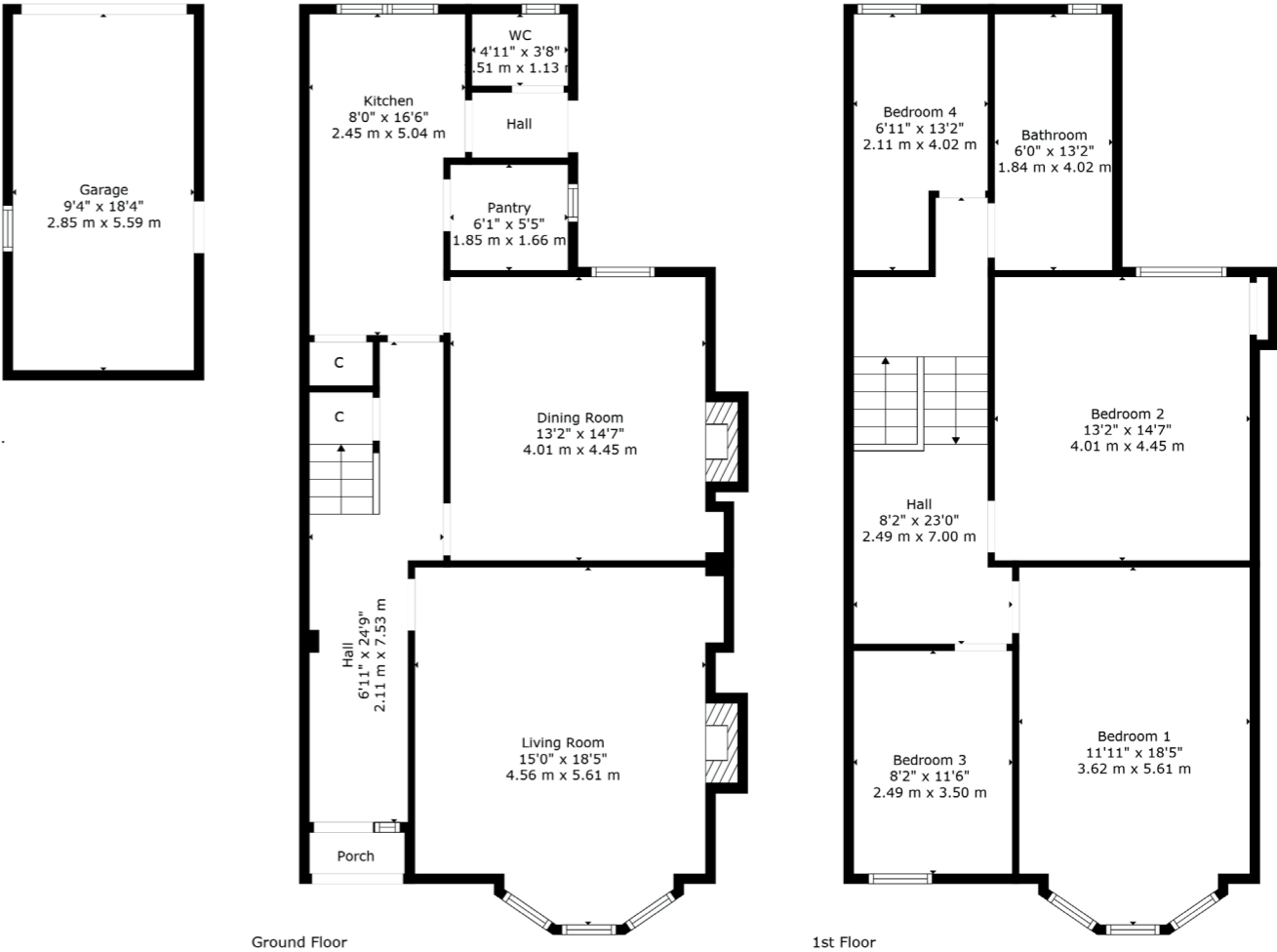

The Scotstoun Conservation Area offers superb local amenities, including nursery, pre-school, primary and secondary education, both within the private and state sectors. The renowned Scotstoun Leisure Centre, home to Glasgow Warriors, offers a wide range of sporting facilities and Victoria Park is also close at hand.

There are a wide range of shops catering for day-to-day needs within the area, along with a choice of restaurants and coffee houses. For commuters, there is a choice of railway stations and regular bus links on the main road arteries providing excellent commuting to the City Centre via the Clydeside Expressway and to the south of the city via the Clyde Tunnel.

WE5418 | Sat Nav: 123 Norse Road, Scotstoun, Glasgow, G14 9EH

For the full home report visit www.corumproperty.co.uk

* All measurements and distances are approximate Floorplans are for illustration purposes and may not be to scale.



WE'RE **SOLD** ON
YOUR FUTURE



Corum West End
82 Hyndland Road, Glasgow, G12 9UT

Tel: 0141 357 1888

Email: westendenq@corumproperty.co.uk

www.corumproperty.co.uk